

## AC-AH-A Right Angle Actuator

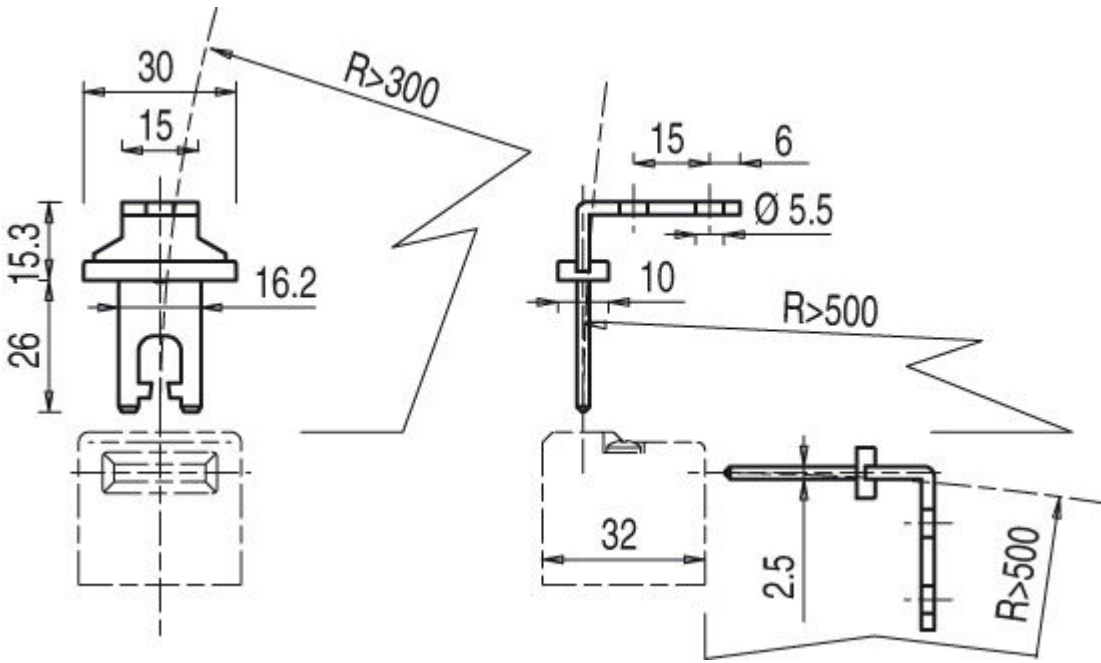

### Dimensioned drawings

All dimensions in millimeters



## Technical Data

<b>Mechanical data</b>	
Dimension (W x H x L)	30 mm x 32.3 mm x 41.3 mm
Net weight	20 g
Type of fastening	Through-hole mounting
Design, actuator	Angled
Area of application, actuator	Heavy duty
Mounting bore holes	In key direction
Material	Stainless steel

<b>Classification</b>	
Customs tariff number	85369095
eCl@ss 8.0	27279216
eCl@ss 9.0	27272606
ETIM 5.0	EC001487
ETIM 6.0	EC001487

See more at [celltec.com.au](https://www.celltec.com.au)

CellTec Pty Ltd

**P:** +61 3 8360 8533 | **E:** [sales@celltec.com.au](mailto:sales@celltec.com.au)

**A:** 6 Paraweena Drive  
Truganina VIC 3029 Australia

**CellTec**  
engineering automation safety