

Head Modules

proAT Head & Tongue Actuator

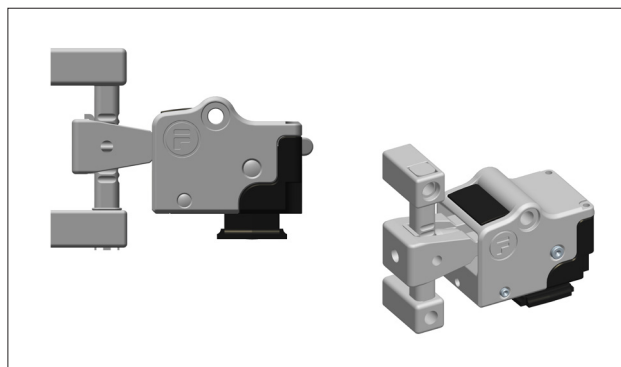

Images above show a TA2T6 (left handed)

proAT Head & Tongue Actuator

- Heavy duty tongue unit.
- Ideal for fast, frequent access.
- 4 position fixing at 90° increments allowing on site handing change.
- Misalignment tolerance of +/- 12mm.
- 12mm Overtravel allowance.
- Retention force 10,000N when top fixing is used.
- Can be fitted with lock-out devices for additional safety.
- Mounted upside down it is self cleaning, ideal for dusty environments.

proAT Head & Tongue Technical Specification

| | |
|--------------------------|--|
| Housing Materials | Zinc Alloy to BSEN12844 Stainless Steel to BS3146 |
| Paint Finish | Gloss powder coat on passivated zinc alloy |
| Colour | Black and Stainless Steel |
| Retention Force (locked) | 10,000N |
| Mechanical Life | >1,000,000 Switching Cycles |
| Performance Level | PLe |
| B10d | 5,000,000 |
| Ambient Temperature | -5°C to 80°C (23°F to 176°F) |
| Environment | Indoor & Outdoor |

proAT Head Options & Ordering Information

| Part Number | Item No. | Description |
|-------------|--------------|----------------------------------|
| T6 | ITM-00038819 | proAT Head |
| T7 | ITM-00038824 | proAT Head c/w Drop Down Lockout |
| T8 | ITM-00038830 | proAT Head c/w ATL Lock-Out Clip |

* The Item No. or Part No. can be quoted for quotation and ordering purposes

Safety Functions - proAT Head

| Safety Function | Retain Actuator | Part No |
|-------------------|--|---------|
| Safety Function 1 | Retain Actuator | T6 |
| Safety Function 2 | Transfer motion of actuator removal into breaking of safety contacts | T7 |
| Safety Function 3 | Prevents insertion of actuator when "locked out" | T8 |

proAT Tongue Options & Ordering Information

| Part No. | Item No. | Item No. |
|----------|-------------------------|--------------|
| TA1 | AT Tongue Front Handing | ITM-00038780 |
| TA2 | AT Tongue Left Handing | ITM-00038806 |
| TA3 | AT Tongue Back Handing | ITM-00038807 |
| TA4 | AT Tongue Right Handing | ITM-00038808 |

* The Item No. or Part No. can be quoted for quotation and ordering purposes

Safety Functions - proAT Tongue

| Safety Function | Part No |
|-------------------|--------------------------------------|
| Safety Function 1 | Provides link from interlock to door |
| | TA |

proAT Head
c/w Drop Down
Lockout

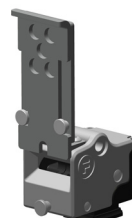

ATL Lock-Out Clip

Dimensional Drawing

